

## Cabinet U-Handles

Steel / Stainless Steel / Aluminum

### SPECIFICATION

#### Version in Steel Handle

Steel

- Powder coated  
Black, RAL 9005, textured finish **SW**
- Chrome plated **CR**
- Blackened **BT**

#### Location disks

Zinc die casting, nickel plated

#### Version in Stainless steel Stainless steel NI

- AISI 303 for  $d_1 = 6, 8, 10$
- AISI 304 for  $d_1 = 12, 16$
- Matte shot-blasted finish **GS**
- Electropolished **EP**
- Location disks for  $d_1 = 6, 8, 10$   
Stainless steel AISI 303

#### Stainless steel AISI 316L A4

- Matte shot-blasted finish **GS**
- Location disks  
Stainless steel AISI 316L

#### Version in Aluminum Aluminum AL

- Powder coated
  - Black, RAL 9005, textured finish **SW**
  - Silver, RAL 9006, textured finish **SR**
  - Red, RAL 3000, textured finish **RS**
- Anodized, natural color **EL**
- Location disks for  $d_1 = 8, 10$   
Zinc die casting, nickel plated



### INFORMATION

Cabinet U-handles GN 425 are manufactured from a bent stainless steel, steel or aluminum profile. Cabinet U-handles with  $\varnothing d_1 = 6, 8$  and 10 are delivered with two location disks to ensure proper contact of the handle even in the case of large connecting holes. The disks are loosely enclosed.

The stainless steel version is preferred over the chrome-plated version for outdoor applications.

### ACCESSORY

- GN 181 Fastening Sets (Mounting from the Operator's Side)  
(see page 488)

### TECHNICAL INFORMATION

- Load Rating Information (see page A35)
- Stainless Steel Characteristics (see page A26)

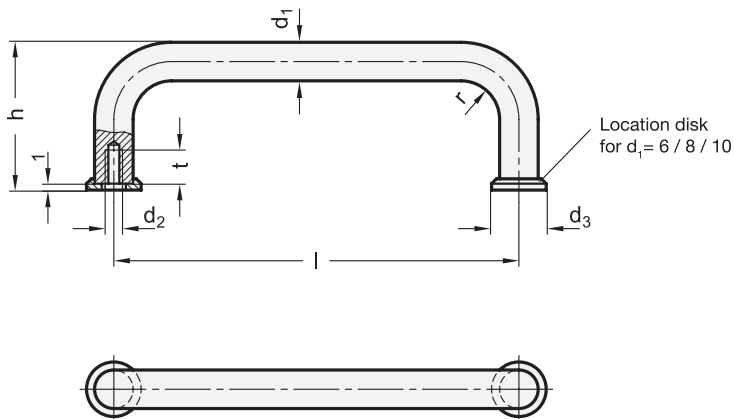

\* Complete with

SW CR BT

GN 425-ST

| Description     | d1 | Length l | d2 | d3 | h  | r  | t min. | ⚖   |
|-----------------|----|----------|----|----|----|----|--------|-----|
| GN 425-6-32-*   | 6  | 32       | M3 | 9  | 26 | 7  | 7      | 16  |
| GN 425-6-45-*   | 6  | 45       | M3 | 9  | 26 | 7  | 7      | 19  |
| GN 425-6-55-*   | 6  | 55**     | M3 | 9  | 26 | 7  | 7      | 22  |
| GN 425-6-64-*   | 6  | 64       | M3 | 9  | 26 | 7  | 7      | 24  |
| GN 425-6-88-*   | 6  | 88**     | M3 | 9  | 26 | 7  | 7      | 29  |
| GN 425-8-55-*   | 8  | 55**     | M4 | 12 | 35 | 10 | 8      | 40  |
| GN 425-8-64-*   | 8  | 64       | M4 | 12 | 35 | 10 | 8      | 43  |
| GN 425-8-88-*   | 8  | 88**     | M4 | 12 | 35 | 10 | 8      | 52  |
| GN 425-8-96-*   | 8  | 96       | M4 | 12 | 35 | 10 | 8      | 57  |
| GN 425-8-100-*  | 8  | 100      | M4 | 12 | 35 | 10 | 8      | 58  |
| GN 425-8-120-*  | 8  | 120**    | M4 | 12 | 35 | 10 | 8      | 68  |
| GN 425-8-128-*  | 8  | 128      | M4 | 12 | 35 | 10 | 8      | 70  |
| GN 425-10-88-*  | 10 | 88**     | M5 | 15 | 43 | 12 | 12     | 87  |
| GN 425-10-100-* | 10 | 100      | M5 | 15 | 43 | 12 | 12     | 98  |
| GN 425-10-120-* | 10 | 120**    | M5 | 15 | 43 | 12 | 12     | 109 |
| GN 425-10-180-* | 10 | 180**    | M5 | 15 | 43 | 12 | 12     | 144 |
| GN 425-10-200-* | 10 | 200      | M5 | 15 | 43 | 12 | 12     | 160 |
| GN 425-10-235-* | 10 | 235**    | M5 | 15 | 43 | 12 | 12     | 183 |
| GN 425-12-125-* | 12 | 125      | M6 | -  | 51 | 14 | 12     | 190 |
| GN 425-12-160-* | 12 | 160      | M6 | -  | 51 | 14 | 12     | 198 |
| GN 425-12-200-* | 12 | 200      | M6 | -  | 51 | 14 | 12     | 231 |
| GN 425-12-250-* | 12 | 250      | M6 | -  | 51 | 14 | 12     | 275 |
| GN 425-16-160-* | 16 | 160      | M6 | -  | 59 | 18 | 12     | 371 |
| GN 425-16-200-* | 16 | 200      | M6 | -  | 59 | 18 | 12     | 430 |
| GN 425-16-250-* | 16 | 250      | M6 | -  | 59 | 18 | 12     | 503 |
| GN 425-16-300-* | 16 | 300      | M6 | -  | 59 | 18 | 12     | 582 |

Weight SW

\*\* suitable for 19" rack and enclosure layout

\* Complete with

GS EP

GN 425-NI

STAINLESS STEEL

| Description        | d1 | Length l | d2 | d3 | h  | r  | t min. | ⚖   |
|--------------------|----|----------|----|----|----|----|--------|-----|
| GN 425-NI-6-32-*   | 6  | 32       | M3 | 9  | 26 | 7  | 7      | 16  |
| GN 425-NI-6-45-*   | 6  | 45       | M3 | 9  | 26 | 7  | 7      | 19  |
| GN 425-NI-6-55-*   | 6  | 55**     | M3 | 9  | 26 | 7  | 7      | 22  |
| GN 425-NI-6-64-*   | 6  | 64       | M3 | 9  | 26 | 7  | 7      | 24  |
| GN 425-NI-6-88-*   | 6  | 88**     | M3 | 9  | 26 | 7  | 7      | 29  |
| GN 425-NI-8-55-*   | 8  | 55**     | M4 | 12 | 35 | 10 | 8      | 40  |
| GN 425-NI-8-64-*   | 8  | 64       | M4 | 12 | 35 | 10 | 8      | 43  |
| GN 425-NI-8-88-*   | 8  | 88**     | M4 | 12 | 35 | 10 | 8      | 52  |
| GN 425-NI-8-96-*   | 8  | 96       | M4 | 12 | 35 | 10 | 8      | 57  |
| GN 425-NI-8-100-*  | 8  | 100      | M4 | 12 | 35 | 10 | 8      | 58  |
| GN 425-NI-8-120-*  | 8  | 120**    | M4 | 12 | 35 | 10 | 8      | 68  |
| GN 425-NI-8-128-*  | 8  | 128      | M4 | 12 | 35 | 10 | 8      | 70  |
| GN 425-NI-10-88-*  | 10 | 88**     | M5 | 15 | 43 | 12 | 12     | 87  |
| GN 425-NI-10-100-* | 10 | 100      | M5 | 15 | 43 | 12 | 12     | 98  |
| GN 425-NI-10-120-* | 10 | 120**    | M5 | 15 | 43 | 12 | 12     | 109 |
| GN 425-NI-10-180-* | 10 | 180**    | M5 | 15 | 43 | 12 | 12     | 144 |
| GN 425-NI-10-200-* | 10 | 200      | M5 | 15 | 43 | 12 | 12     | 160 |
| GN 425-NI-10-235-* | 10 | 235**    | M5 | 15 | 43 | 12 | 12     | 183 |
| GN 425-NI-12-125-* | 12 | 125      | M6 | -  | 51 | 14 | 12     | 190 |
| GN 425-NI-12-160-* | 12 | 160      | M6 | -  | 51 | 14 | 12     | 198 |
| GN 425-NI-12-200-* | 12 | 200      | M6 | -  | 51 | 14 | 12     | 231 |
| GN 425-NI-12-250-* | 12 | 250      | M6 | -  | 51 | 14 | 12     | 275 |
| GN 425-NI-16-160-* | 16 | 160      | M6 | -  | 59 | 18 | 12     | 371 |
| GN 425-NI-16-200-* | 16 | 200      | M6 | -  | 59 | 18 | 12     | 430 |
| GN 425-NI-16-250-* | 16 | 250      | M6 | -  | 59 | 18 | 12     | 503 |
| GN 425-NI-16-300-* | 16 | 300      | M6 | -  | 59 | 18 | 12     | 582 |

Weight GS

\*\* suitable for 19" rack and enclosure layout



U-Handles 4

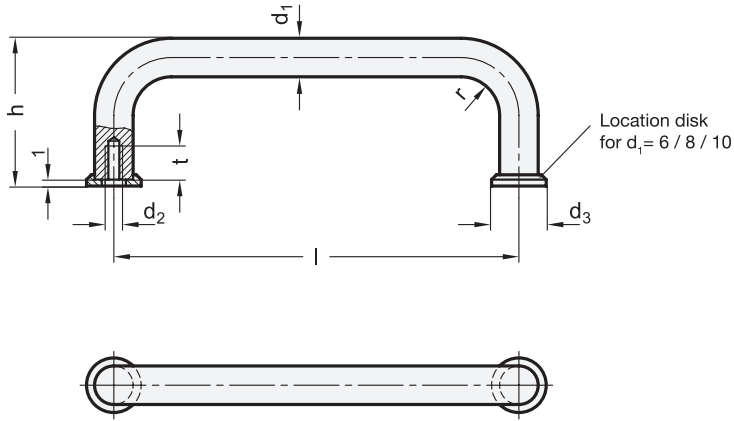

### GN 425-A4

STAINLESS STEEL

| Description         | $d_1$ | Length $l$ | $d_2$ | $d_3$ | $h$ | $r$ | $t$ min. | $\Delta$ |
|---------------------|-------|------------|-------|-------|-----|-----|----------|----------|
| GN 425-A4-10-88-GS  | 10    | 88**       | M 5   | 15    | 43  | 12  | 12       | 87       |
| GN 425-A4-10-100-GS | 10    | 100        | M 5   | 15    | 43  | 12  | 12       | 98       |
| GN 425-A4-10-120-GS | 10    | 120**      | M 5   | 15    | 43  | 12  | 12       | 109      |
| GN 425-A4-10-180-GS | 10    | 180**      | M 5   | 15    | 43  | 12  | 12       | 144      |
| GN 425-A4-10-200-GS | 10    | 200        | M 5   | 15    | 43  | 12  | 12       | 160      |
| GN 425-A4-10-235-GS | 10    | 235**      | M 5   | 15    | 43  | 12  | 12       | 183      |

\* Complete with



### GN 425-AL

| Description        | $d_1$ | Length $l$ | $d_2$ | $d_3$ | $h$ | $r$ | $t$ min. | $\Delta$ |
|--------------------|-------|------------|-------|-------|-----|-----|----------|----------|
| GN 425-AL-8-55-*   | 8     | 55**       | M 4   | 12    | 35  | 10  | 8        | 17       |
| GN 425-AL-8-64-*   | 8     | 64         | M 4   | 12    | 35  | 10  | 8        | 18       |
| GN 425-AL-8-88-*   | 8     | 88**       | M 4   | 12    | 35  | 10  | 8        | 20       |
| GN 425-AL-8-96-*   | 8     | 96         | M 4   | 12    | 35  | 10  | 8        | 23       |
| GN 425-AL-8-100-*  | 8     | 100        | M 4   | 12    | 35  | 10  | 8        | 24       |
| GN 425-AL-8-120-*  | 8     | 120**      | M 4   | 12    | 35  | 10  | 8        | 26       |
| GN 425-AL-8-128-*  | 8     | 128        | M 4   | 12    | 35  | 10  | 8        | 28       |
| GN 425-AL-10-88-*  | 10    | 88**       | M 5   | 15    | 43  | 12  | 12       | 32       |
| GN 425-AL-10-100-* | 10    | 100        | M 5   | 15    | 43  | 12  | 12       | 38       |
| GN 425-AL-10-120-* | 10    | 120**      | M 5   | 15    | 43  | 12  | 12       | 41       |
| GN 425-AL-10-180-* | 10    | 180**      | M 5   | 15    | 43  | 12  | 12       | 55       |
| GN 425-AL-10-200-* | 10    | 200        | M 5   | 15    | 43  | 12  | 12       | 57       |
| GN 425-AL-10-235-* | 10    | 235**      | M 5   | 15    | 43  | 12  | 12       | 59       |
| GN 425-AL-12-125-* | 12    | 125        | M 6   | -     | 51  | 14  | 12       | 60       |
| GN 425-AL-12-160-* | 12    | 160        | M 6   | -     | 51  | 14  | 12       | 71       |
| GN 425-AL-12-200-* | 12    | 200        | M 6   | -     | 51  | 14  | 12       | 83       |
| GN 425-AL-12-250-* | 12    | 250        | M 6   | -     | 51  | 14  | 12       | 102      |
| GN 425-AL-16-160-* | 16    | 160        | M 6   | -     | 59  | 18  | 12       | 128      |
| GN 425-AL-16-200-* | 16    | 200        | M 6   | -     | 59  | 18  | 12       | 146      |
| GN 425-AL-16-250-* | 16    | 250        | M 6   | -     | 59  | 18  | 12       | 180      |
| GN 425-AL-16-300-* | 16    | 300        | M 6   | -     | 59  | 18  | 12       | 205      |

Weight SW

\*\* suitable for 19" rack and enclosure layout

